

BALANCING ACT

Ángel Sánchez + Vicente Tomás | © Alejo Bagué | Majorca, Spain

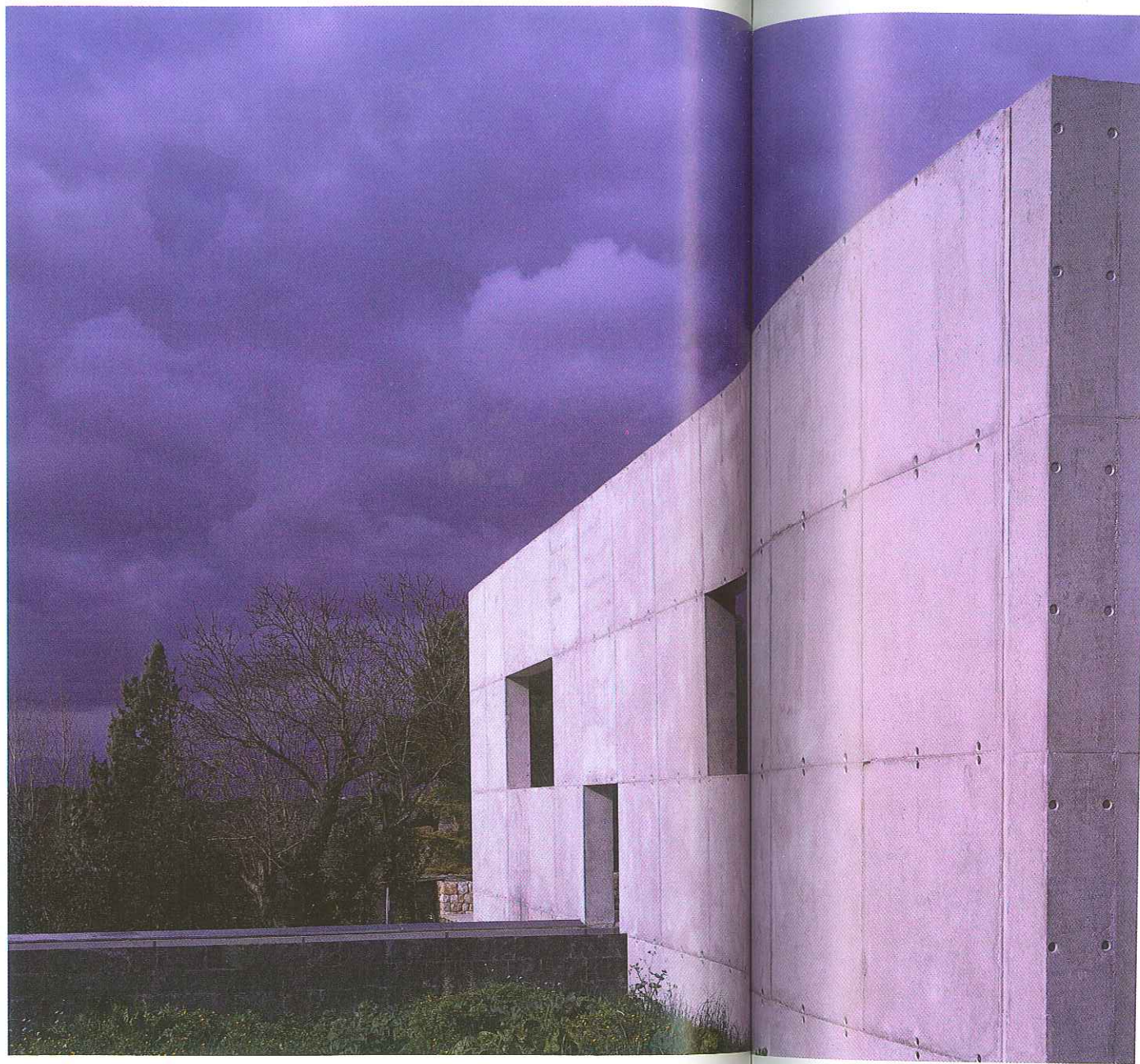



72 BALANCING ACT

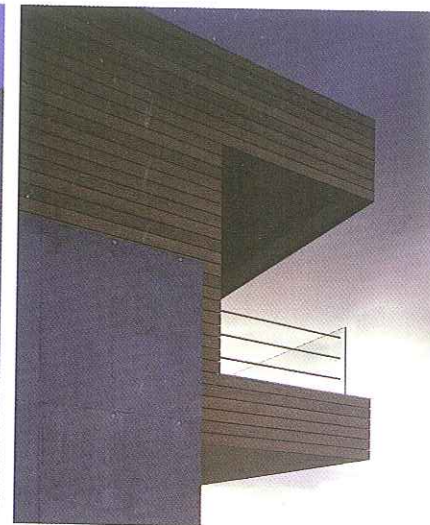

The structure is defined by a concrete base, and a concrete wall wraps around one corner of the plot, containing a large, landscaped patio.



Openings in the concrete walls guide the eye through a framed view of the landscape beyond. The project intends to find a balance in architecture inspired by nature.

